

EASTERN

VALLEY

WAY

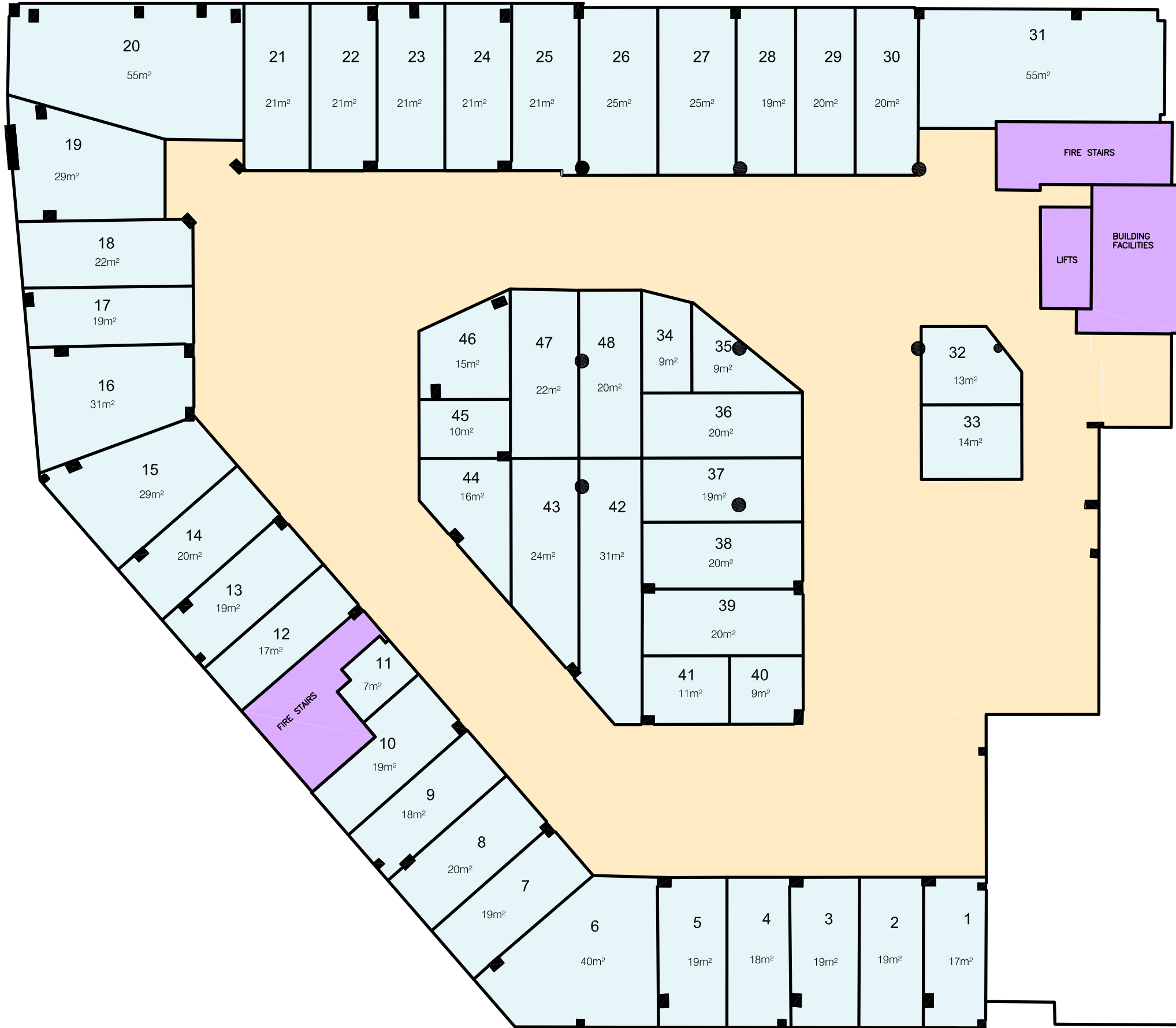

- STORAGE UNITS
- ACCESSWAY
- BUILDING SERVICES

| No. | DATE | REVISION DETAILS |
|-----|------|------------------|
|     |      |                  |
|     |      |                  |
|     |      |                  |

COPYRIGHT © WHELANS OPERATIONS PTY LTD. INFORMATION CONTAINED IN THIS DRAWING / FILE IS THE COPYRIGHT OF WHELANS OPERATIONS PTY LTD. COPYING OR USING THIS DATA IN WHOLE OR PART, IN ANY FORMAT, WITHOUT PERMISSION IS PROHIBITED.

THIS DOCUMENT IN BOTH ELECTRONIC AND HARD COPY FORMAT IS AND SHALL REMAIN THE PROPERTY OF WHELANS OPERATIONS PTY LTD. THE INFORMATION MAY ONLY BE USED FOR THE PURPOSE FOR WHICH IT WAS COMMISSIONED AND IN ACCORDANCE WITH THE TERMS OF ENGAGEMENT FOR THE COMMISSION. UNAUTHORIZED USE OF THIS INFORMATION IN ANY FORM WHATSOEVER IS PROHIBITED.

PREPARED BY:

**Whelans**  
Whelans Operations Pty Ltd  
ACN: 088 148 743  
Level 5, 55 York Street  
Sydney, NSW 2000  
DX 288 Sydney  
t: 02 9254 8306  
f: 02 9282 6511  
whelanslic.com.au

PREPARED FOR:  
EWW INVESTMENT PTY. LTD.

Plan showing final areas for storage units on level 1,  
384 Eastern Valley Way,  
East Roseville

|                            |                         |
|----------------------------|-------------------------|
| ORIGINAL SIZE:             | <b>A1</b>               |
| SCALE: HOR: 1:100          | VERT:                   |
| CO-ORDS:                   | DATUM:                  |
| DATE OF SURVEY: 30.03.2006 | DATE OF PLAN: 4.04.2006 |
| SURVEY: HDT                | DRAWN: PLH              |
| CHECKED:                   | DATE:                   |
| APPROVED:                  | DATE:                   |
| JOB REF: B841              |                         |
| CAD REF: B841-022.dwg      | SHEET 1 OF 1 SHEETS     |

LEVEL 1